

**NEUTRONE®**

**SINGLE STAGE BACK PULL-OUT  
END SUCTION CENTRIFUGAL PUMP**

**BP SERIES**



**APPLICATIONS**

- \* Air Conditioning
- \* Fire Protection
- \* Circulating
- \* Irrigation
- \* Pressure Boosting
- \* Water Treatment & Supply
- \* Refrigeration
- \* Plumbing
- \* Liquid Transfer
- \* Drainage
- \* De-watering
- \* Cooling Towers

# NEUTRONE®

# SINGLE STAGE BACK PULL-OUT END SUCTION CENTRIFUGAL PUMP

## BP SERIES

### Description

Volute casing centrifugal end suction pump with Back Pull-Out (BPO) feature, main dimensions and performance according to EN733/DIN24255 standards.

**Type** : End Suction Centrifugal, Back Pull-Out Design

**Design** : EN733/DIN24255

**Flange** : DIN2332 PN 10RF

**Direction of Rotation** : Clockwise as viewed from the drive shaft

### Material

**Casing** : Cast Iron, Bronze and Stainless Steel

**Impeller** : Cast Iron, Bronze and Stainless Steel

**Shaft** : 2Cr13, (optional AISI304 & AISI316 )

**Shaft Seal** : Mechanical Seal and Gland Packing

### Operating Range

**Flow Rate(Q)** : up to **1100m<sup>3</sup>/h**

**Head(H)** : up to **150m**

**Speed** : **1450 ~ 2900 rpm (50Hz) & 1750 ~ 3600 rpm (60Hz)**

**Operating Temp.** : **-10 °C to 80 °C** standard (optional 150 °C)

**Operating Pressure** : **10 bar standard** (optional 16 Bar)

### Application

pumps can be used for the following services in the Commercial, Residential, Agricultural, Industrial, Process, Petroleum and Food & Beverage industries.

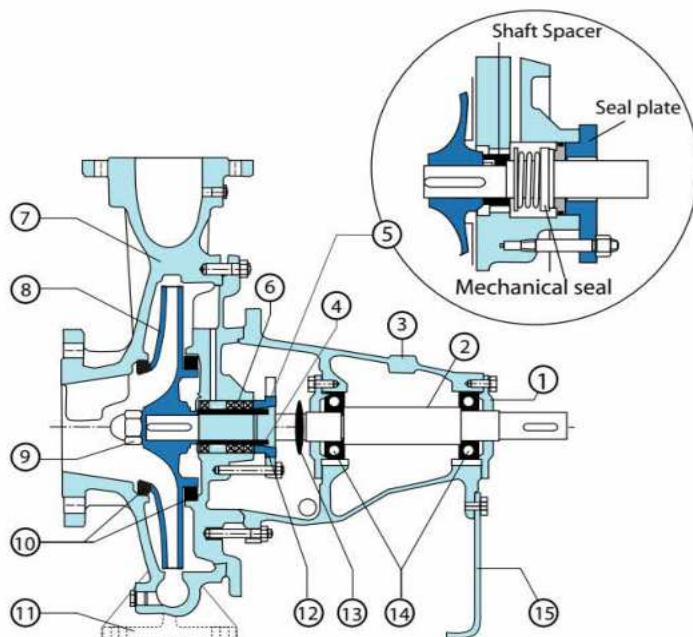

### Parts:

- | No. | Name                   |
|-----|------------------------|
| 1   | Bearing Cover          |
| 2   | Shaft                  |
| 3   | Bearing Housing        |
| 4   | Shaft Sleeve           |
| 5   | Mechanical Seal        |
| 6   | Gland Packing (Option) |
| 7   | Volute Casing          |
| 8   | Impeller               |
| 9   | Impeller Nut           |
| 10  | Casing Wear Rings      |
| 11  | Front Foot Support     |
| 12  | Seal Plate             |
| 13  | Slinger                |
| 14  | Ball Bearings          |
| 15  | Rear Foot Support      |

# NEUTRONE®

# SINGLE STAGE BACK PULL-OUT END SUCTION CENTRIFUGAL PUMP

## BP SERIES

### 2900 RPM

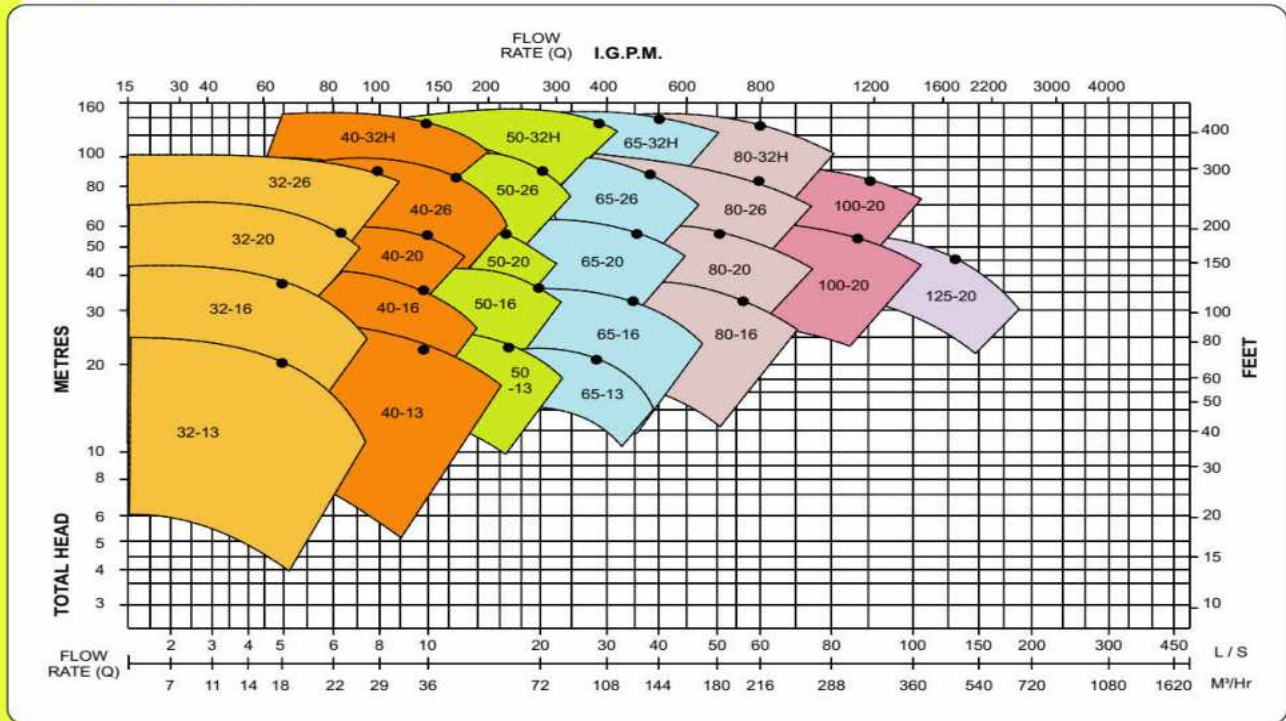

### 1450 RPM

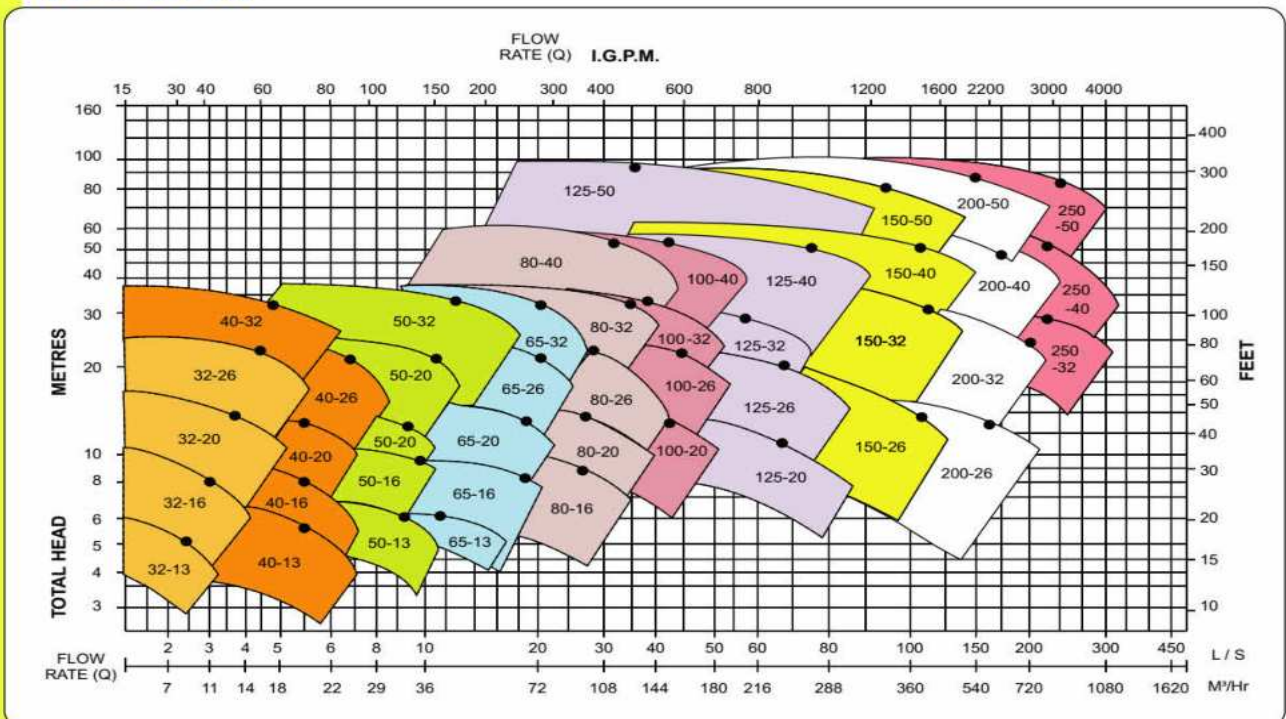

# NEUTRONE®

# SINGLE STAGE BACK PULL-OUT END SUCTION CENTRIFUGAL PUMP

## BP SERIES

### Installing Dimensions

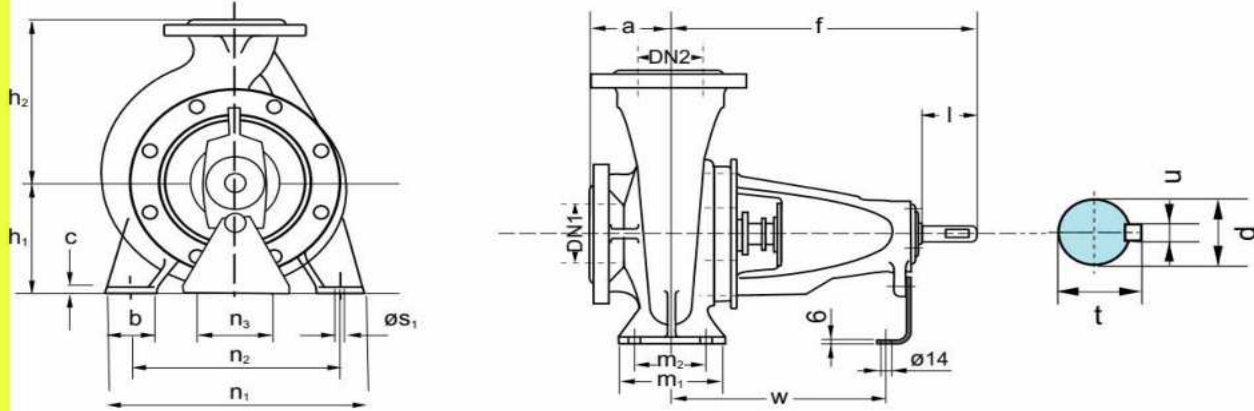

Pump Model	Bearing Housing	Discharge DN <sub>2</sub>	Suction DN <sub>1</sub>	Pump Dimension					Foot Dimension							Shaft End				Net Weight																									
				a	f	h <sub>1</sub>	h <sub>2</sub>	b	c	n <sub>3</sub>	m <sub>1</sub>	m <sub>2</sub>	n <sub>1</sub>	n <sub>2</sub>	s	w	d	l	t		u																								
BP32/13	25	32	50	80	360	112	140	50	100	100	70	190	140	267	24	50	27	8	28																										
BP32/16						132	160					240	190						36																										
BP32/20						160	180					320	250						43																										
BP32/26				180	225	320	250	63																																					
BP40/13				112	140	210	160	31																																					
BP40/16				132	160	240	190	37																																					
BP40/20	160	180	265	212	46																																								
BP40/26	180	225	320	250	63																																								
BP40/32	35	40	65	125	470	200	250	65	14	110	125	95	345	280	14	342	32	80	35	10	96																								
BP40/32H	45			523	200	250	364	42													110	45	12	96																					
BP50/13	25			50	100	360	132	160													50	100	100	70	240	190	267	24	50	27	8	34													
BP50/16							160	180																	265	212						38													
BP50/20							160	200																	320	250						48													
BP50/26							180	225																	320	250						65													
BP50/32	35	65	80	125	470	225	280	65	110	125	95	345	280	14	342	32	80	35	10	101																									
BP50/32H	45			523	225	280	364	42												110	45	12	101																						
BP65/13	25			50	100	360	160	180												65	14	125	95	280	212	267	24	50	27	8	40														
BP65/16							160	200																320	250						44														
BP65/20							180	225																360	250						54														
BP65/26							200	250																360	250						83														
BP65/32	35	80	100	100	470	225	280	80	15	160	120	400	315	18	342	32	80	35	10	110																									
BP65/32H	45				523	225	280	364												42	110	45	12	110																					
BP80/16	35				50	125	360	180												225	65	14	125	95	320	250	267	24	50	27	8	55													
BP80/20								180												250					345	280						72													
BP80/26								200												280					360	250						92													
BP80/32								250												315					400	315						120													
BP80/32H	45	80	100	125	523	250	315	80	16	160	120	435	355	18	361	42	110	45	12	120																									
BP80/40	530				280	355	85													18	370	42	110	45	12	162																			
BP100/16	35				50	140	360													200	250	80	15	200	150	500	400	22	370	42	110	45	12	177											
BP100/20																				280	280	600	400											111											
BP100/26																				225	280	80	16											160	120	400	315	18	342	32	80	35	10	115	
BP100/32																				250	315	100	18											200	150	500	400	23	370	42	110	45	12	190	
BP100/40	45	100	125	140	530	280	355	100	20	200	150	620	500	26	400	55	110	45	12	*																									
BP125/20	35				530	280	400	342	32											80	35	10	145																						
BP125/26	45				50	160	360	200	250											80	15	200	150	400	315	23	370	42	110	45	12	164													
BP125/32								280	355											100	18											550	450	175	210										
BP125/40								315	400											100	18											630	355	500	120	35	180	250	180	670	550	20	400	55	*
BP125/50*								530	315											450	100											35	180	250	180	620	500	26	400	55	110	45	12	*	
BP150/20	45	50	180	360	250	355	500	120	35	200	150	550	450	20	370	42	110	45	12	164																									
BP150/26					315	450	100	18	630											355	500	120	35	180	250	180	670	550	20	400	55	*													
BP150/32					530	315	450	100	35											180	250	180	620	500	26	400	55	110	45	12	*														
BP150/40					630	355	500	120	35											180	250	180	670	550	20	400	55	110	45	12	*														
BP150/50*	55	50	200	360	530	315	450	100	18	220	170	600	480	28	505	48	110	45	12	270																									
BP200/26					530	315	450	100	30											140	300	240	720	600	27	511	55	45	12	*															
BP200/32					670	315	480	120	20											110	220	170	600	480	28	505	48	51	14	14	331														
BP200/40					335	480	120	20	110											250	200	660	510	28	525	48	51	14	14	415															
BP200/50*	60	50	250	300	210	875	400	500	160	30	140	300	240	720	600	27	511	55	45	12	*																								
BP250/32					691	355	520	150	26	110	250	200	660	510	28	525	48	51	14	14	331																								
BP250/40	55	50	300	300	682	400	560	150	26	110	250	200	660	510	28	516	48	51	14	14	415																								
BP250/50*					875	425	545	160	30	140	300	200	720	600	27	626	70	140	45	12	*																								

\*Pumps dimension may vary, please refer to manufacturer.