

NEUTRONE®

AIR OPERATED DIAPHRAGM PUMP

DW series



Application

Chemical Transfer

Waste Water Transfer

Oil & Gas Industry

Ceramic Industry

Printing Industry

Marine Industry

Food Industry

Shipping Industry

NEUTRONE®

AIR OPERATED DIAPHRAGM PUMP

DW-15PP



Performance curve

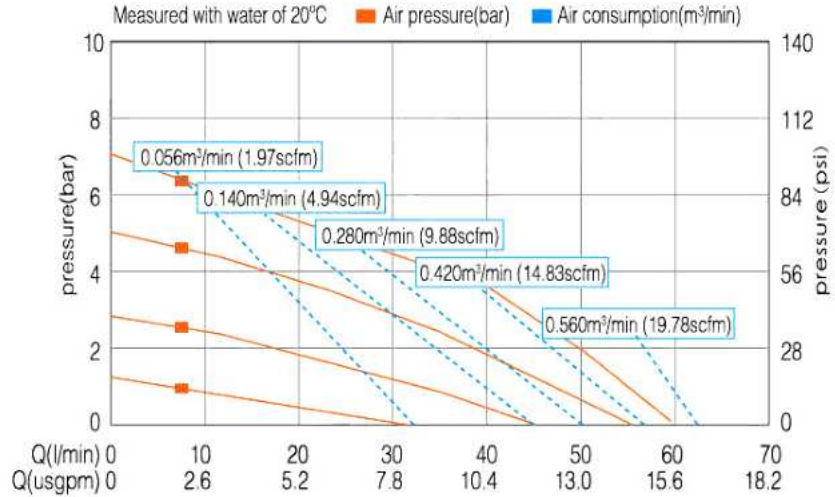

Technical Parameters

Max. Suction Lift	dry 5 m wet 7.6m
Suction height changes with the different combinations of ball, seat and the diaphragm materials.	
Max. particle diameter	2.5 mm
Suction and discharge size	1/2" or 3/4"
Air inlet size	1/4"
Max. flow rate	57 L/min
Max. head	84m
Max. air inlet pressure	8.4bar
Max. air consumption	28 scfm (0.67 m³ /min)
Main body material	Polypropylene

Installation Size

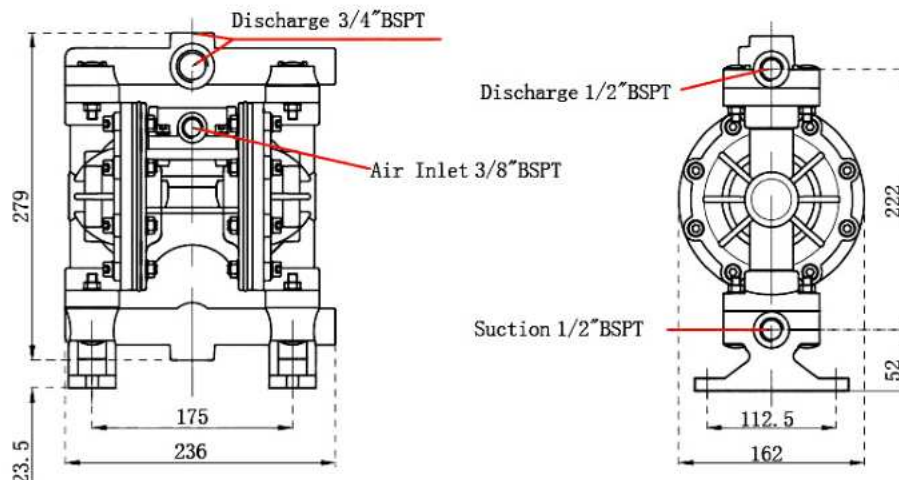

NEUTRONE®

AIR OPERATED DIAPHRAGM PUMP

DW-25PP



Performance curve

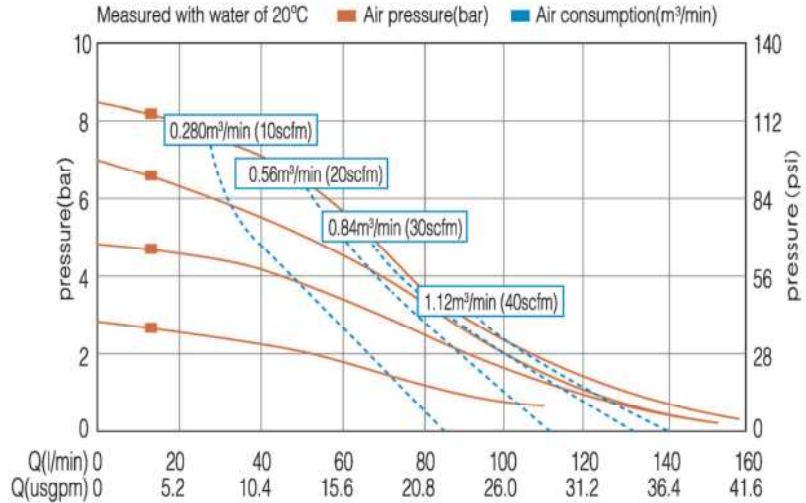

Technical Parameters

Max. Suction Lift Suction height changes with the different combinations of ball, seat and the diaphragm materials.	dry 4m wet 8m
Max. particle diameter	4 mm
Suction and discharge size	1 in
Air inlet size	1/2 in
Max. flow rate	157 L/min
Max. head	84m
Max. air inlet pressure	8.4bar
Main body material	PP

Installation Size

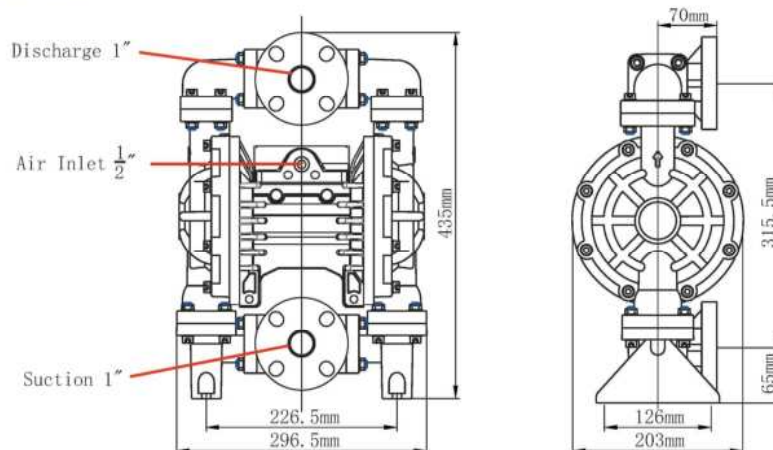

AIR OPERATED DIAPHRAGM PUMP

DW-40PP



Performance curve

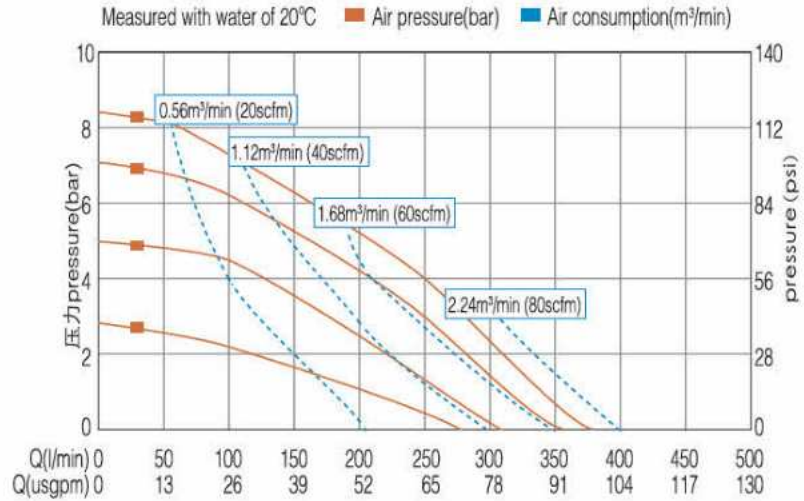

Technical Parameters

Max. Suction Lift Suction height changes with the different combinations of ball, seat and the diaphragm materials.	dry 5m wet 8m
Max. particle diameter	5mm
Suction and discharge size	1-1/2 in F
Air inlet size	1/2 in
Max. flow rate	358 L/min
Max. head	84m
Max. air inlet pressure	8.4bar
Max. air consumption	125scfm (3.5m³ /min)
Main body material	PP PVDF

Installation Size

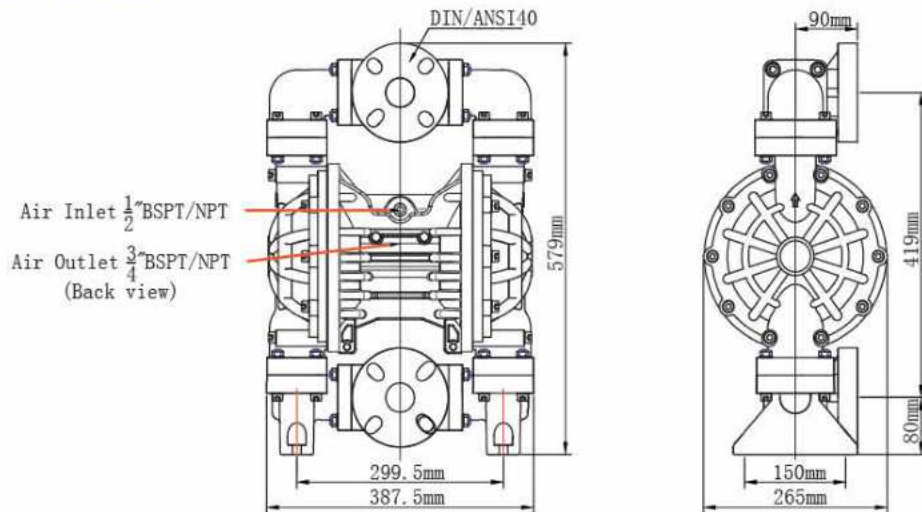

NEUTRONE®

AIR OPERATED DIAPHRAGM PUMP

DW-50PP



Performance curve

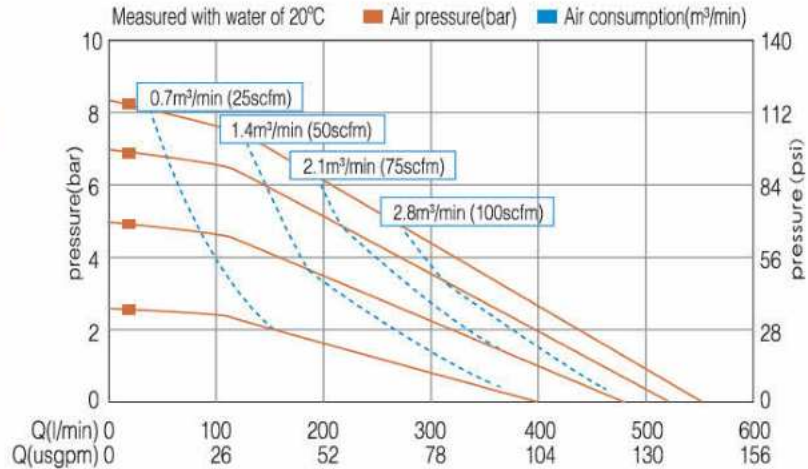

Technical Parameters

Max. Suction Lift Suction height changes with the different combinations of ball, seat and the diaphragm materials.	dry 5m wet 8m
Max. particle diameter	6mm
Suction and discharge size	2" Flange
Air inlet size	1/2"
Max. flow rate	587L/min
Max. head	84m
Max. air inlet pressure	8.4bar
Max. air consumption	175scfm (4.9 m³/hr)
Main body material	PP PVDF

Installation Size

PP - 25kg
PVDF - 34kg

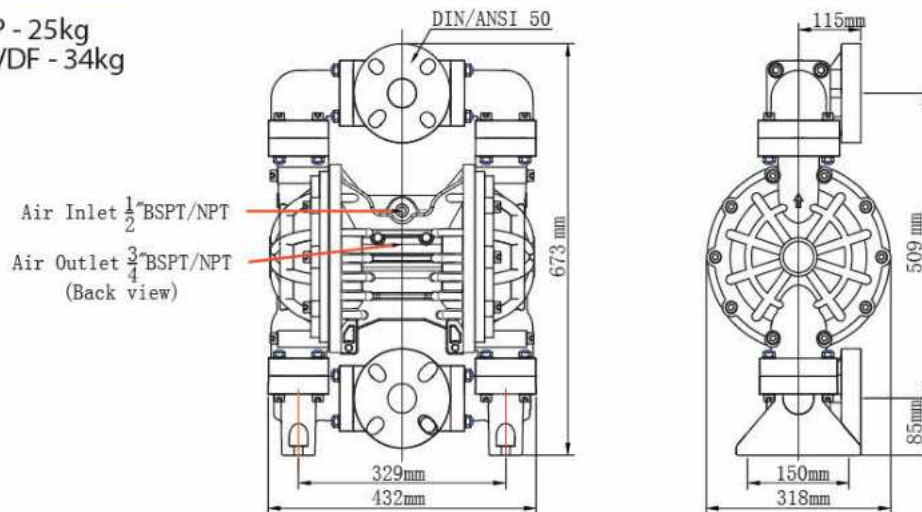

NEUTRONE®

AIR OPERATED DIAPHRAGM PUMP

DW-80PP



Performance curve

Measured with water of 20°C Air pressure(bar) Air consumption(m³/min)

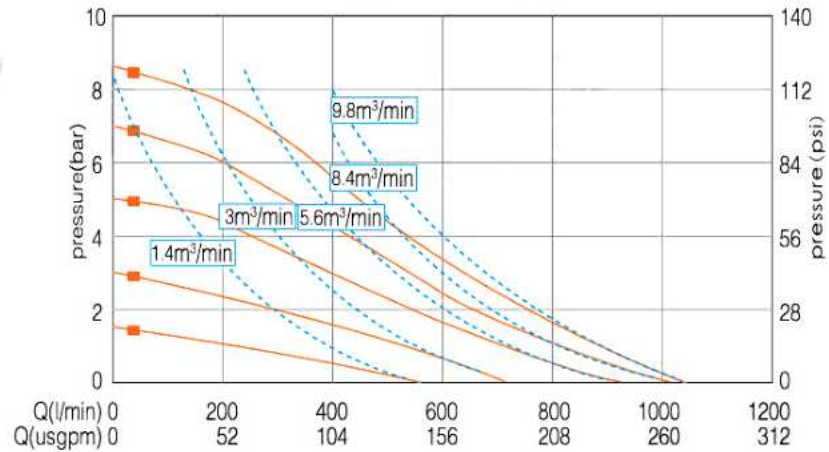

Technical Parameters

Max. Suction Lift Suction height changes with the different combinations of ball, seat and the diaphragm materials.	dry 5m wet 8m
Max. particle diameter	9.4 mm
Suction and discharge size	3"
Air inlet size	3/4"
Max. flow rate	1060 L/min
Max. head	84m
Max. air inlet pressure	8.4bar
Max. air consumption	325 scfm (9.1 m³ /min)
Main body material	PP / PVDF

Installation Size

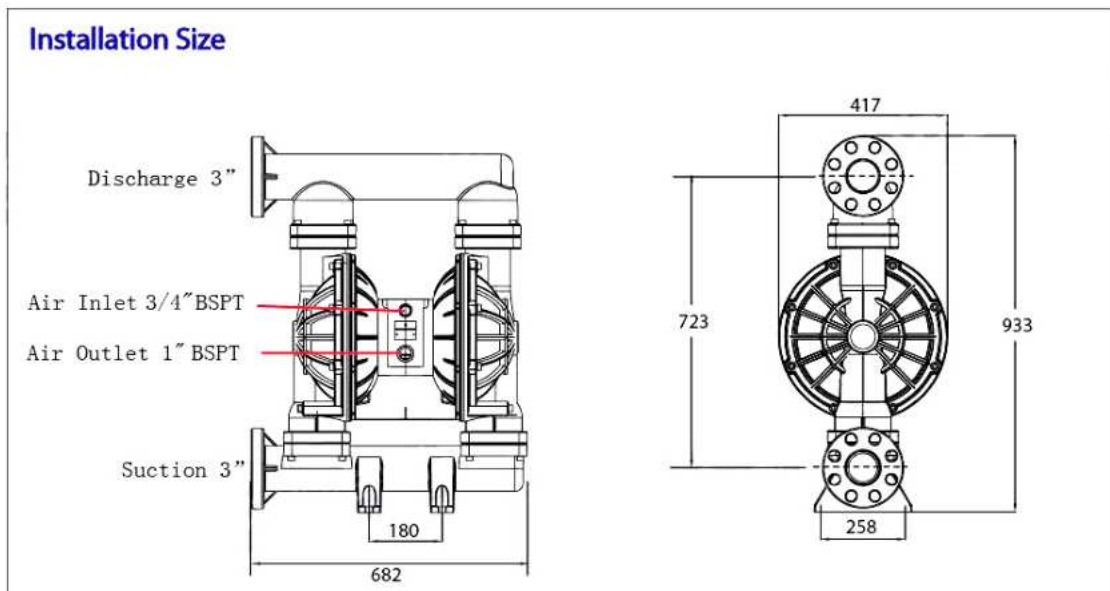

DW-25AL



Performance curve

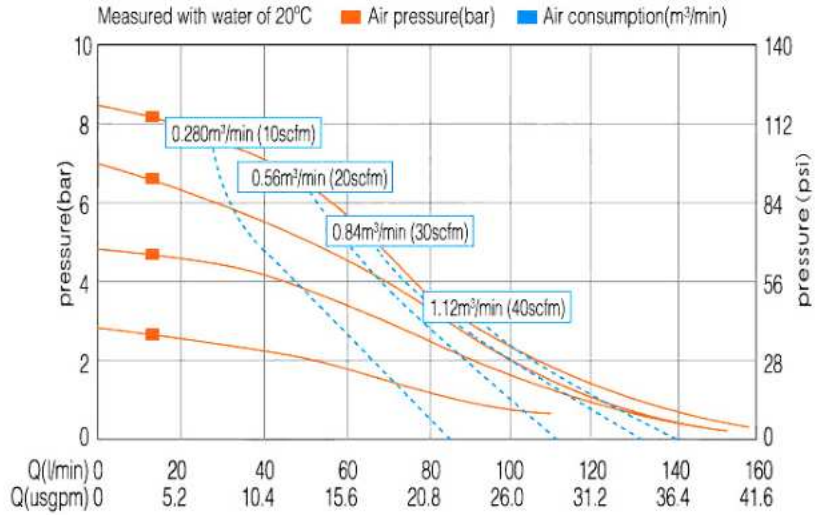

Technical Parameters

Max. Suction Lift	dry 4m wet 8m
Suction height changes with the different combinations of ball, seat and the diaphragm materials.	
Max. particle diameter	4 mm
Suction and discharge size	1 in
Air inlet size	1/2 in
Max. flow rate	157 L/min
Max. head	84m
Max. air inlet pressure	8.4bar
Main body material	Aluminum alloy

Installation Size

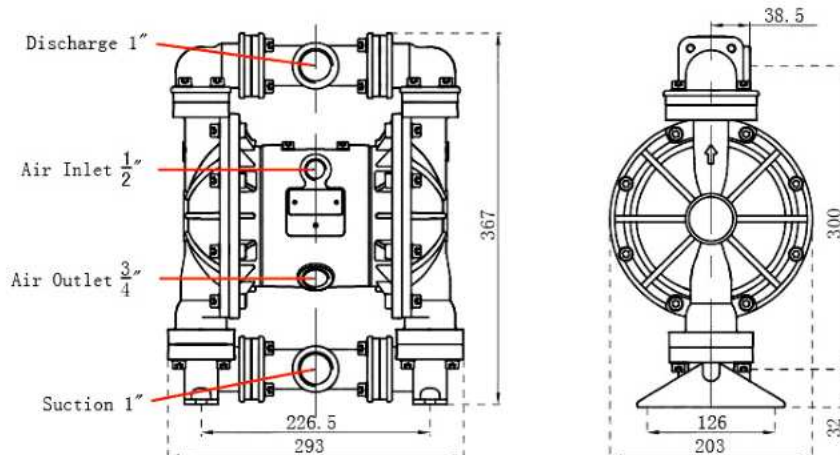

NEUTRONE®

AIR OPERATED DIAPHRAGM PUMP

DW-40AL



Performance curve

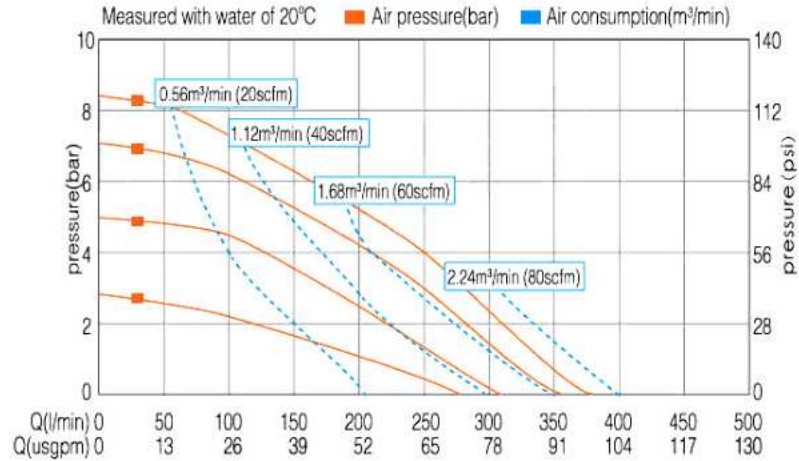

Technical Parameters

Max. Suction Lift	dry 5m wet 8m
Suction height changes with the different combinations of ball, seat and the diaphragm materials.	
Max. particle diameter	5mm
Suction and discharge size	1 1/2 in
Air inlet size	1/2in
Max. flow rate	358 L/min
Max. head	84m
Max. air inlet pressure	8.4bar
Max. air consumption	125scfm (3.5m³ /min)
Main body material	Aluminum alloy

Installation Size

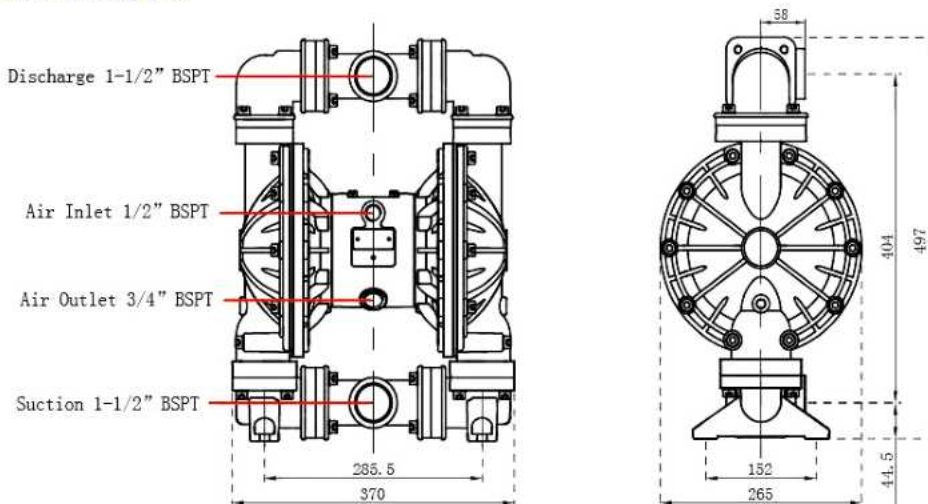

NEUTRONE®

AIR OPERATED DIAPHRAGM PUMP

DW-50AL



Performance curve

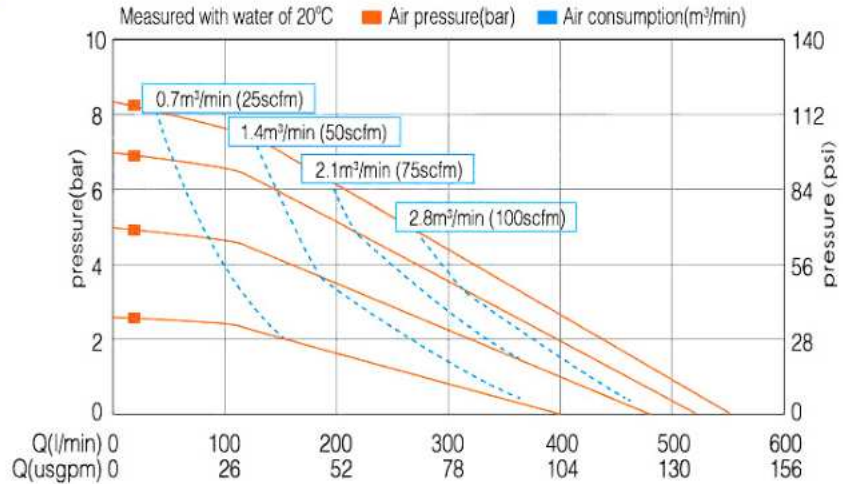

Technical Parameters

Max. Suction Lift	dry 5m wet 8m
Suction height changes with the different combinations of ball, seat and the diaphragm materials.	
Max. particle diameter	6 mm
Suction and discharge size	2 in
Air inlet size	1/2 in
Max. flow rate	587 L/min
Max. head	84m
Max. air inlet pressure	8.4bar
Max. air consumption	175scfm (4.9m³/min)
Main body material	Aluminum alloy

Installation Size

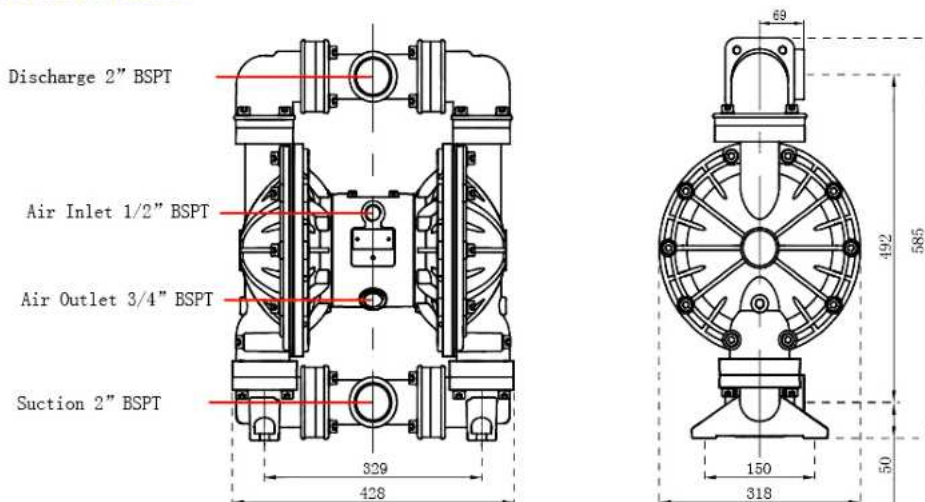

NEUTRONE®

AIR OPERATED DIAPHRAGM PUMP

DW-80AL



Performance curve

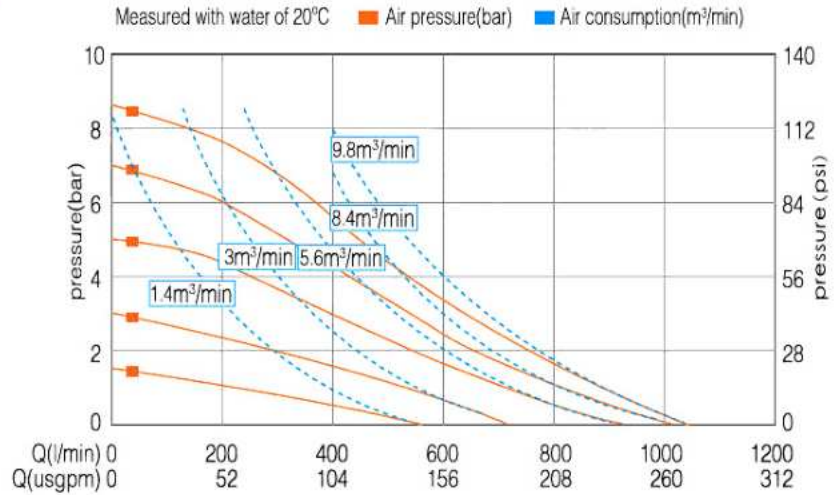

Technical Parameters

Max. Suction Lift	dry 5m wet 8m
Suction height changes with the different combinations of ball, seat and the diaphragm materials.	
Max. particle diameter	9.4 mm
Suction and discharge size	3"
Air inlet size	3/4"
Max. flow rate	1060 L/min
Max. head	84m
Max. air inlet pressure	8.4bar
Max. air consumption	325 scfm (9.1 m³ /min)
Main body material	Aluminum alloy

Installation Size

